



Strawberry
Housing pvt ltd,
Premium Apartments

*seek home for rest,
for home is best.*

@ Villivakkam
Siva shakthi colony



SDR
CONSTRUCTION
Creates your unique ID...



www.sdrconstruction.in

CAR PARKING

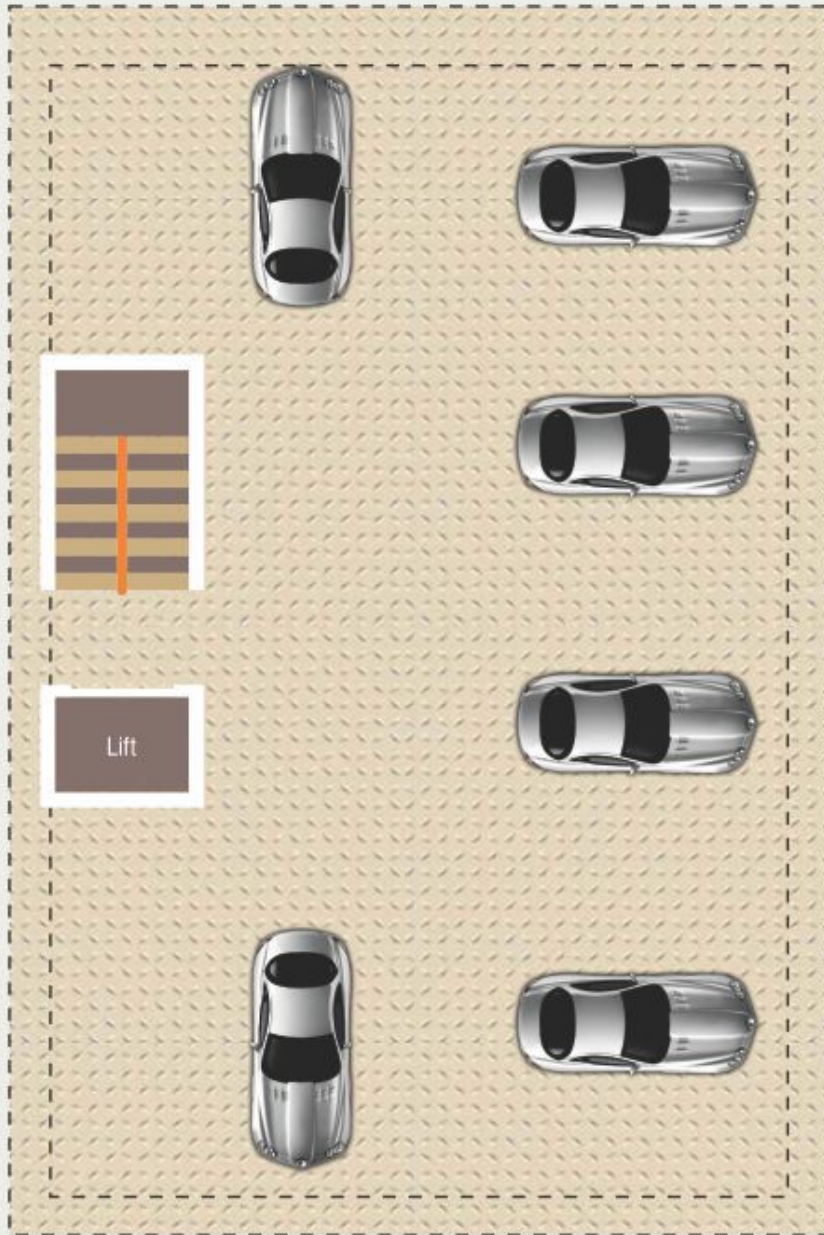

1st FLOOR



2nd FLOOR



KEYPLAN - not to Scale

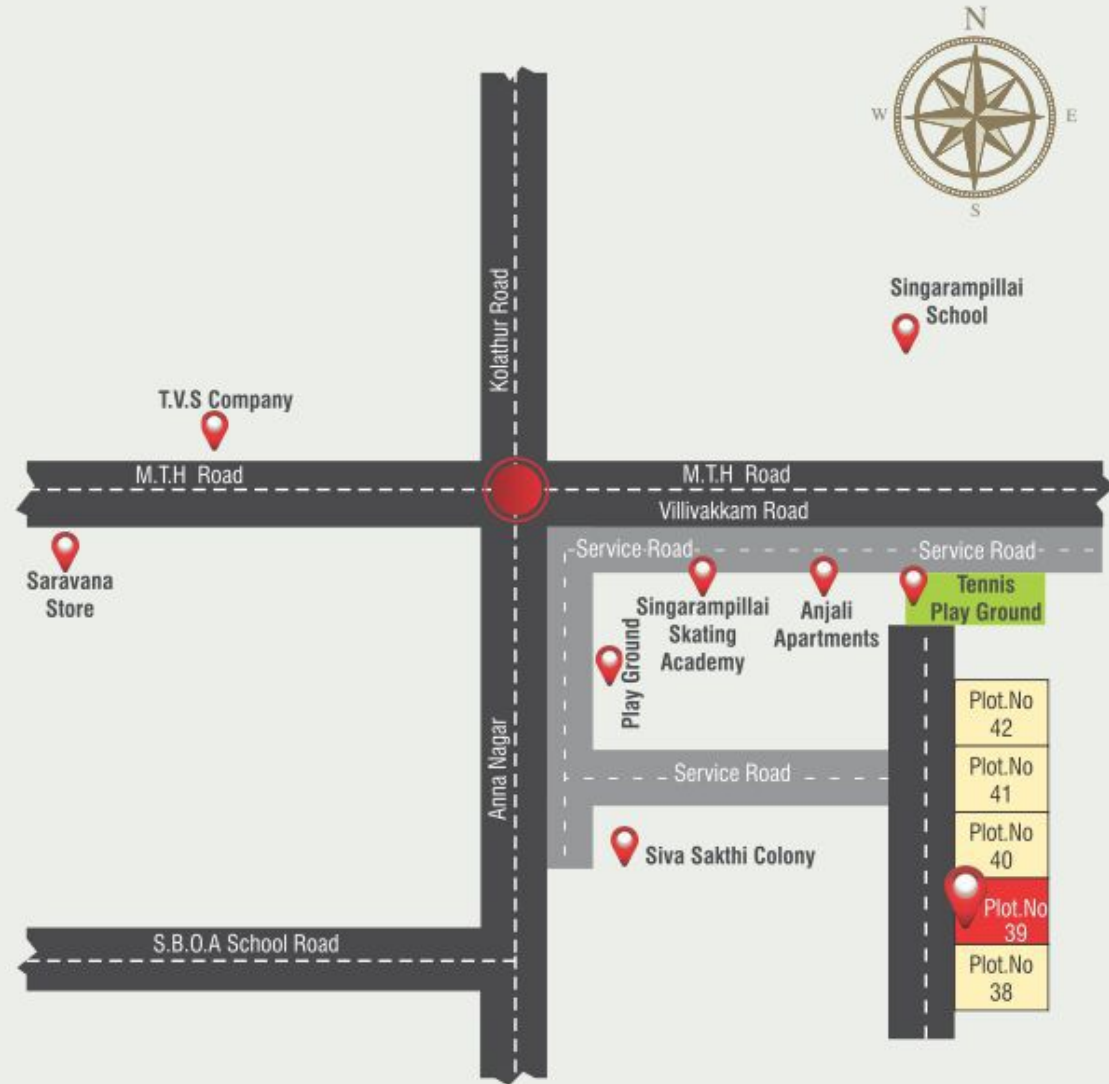

SPECIFICATION

- Structure** : RCC frame structure with 9" brick external walls and 4 1/2" brick partition wall.
- Design** : Architect design as per vastu.
- Plastering** : Ceiling, inner & outer walls plastering in cement with neat finish.
- Flooring** : 2' x 2' Vitrified Tiles in all rooms with 4" skirting.
- Main door** : Quality Teak Wood frame with Panelled door with varnish finish and brass fittings.
- Other door** : Quality Country Wood frame with flush door with enamel Paint and power coated fitting.
- Window** : Wood frame with glazed shutters - openable windows with M.S. Grills.
- Plumbing** : Concealed CPVC Pipe Line in bathroom, PVC pipes for rain water, sanitary waste
- Sanitary** : Line and under ground drainage. Bath rooms with bore well water.
- Kitchen** : 20 mm Black granite counter with stainless steel sink with drain board, will be provided.
- Toilet** : EWC / IWC white color sanitary ware (Parryware or Equivalent) Washing machine point, Geyser point, One shower point, Glazed tiles upto 7' height, Wash Basins.

- Painting** : Grills - Zink Chromite non-corrosive primer with enamel paint.
- Electrical** : Three Phase power supply with concealed wiring of ISI Anchor Switches or Equivalent Earth leak circuit breaker.
The electrical points as per architects drawing.
- Lofts** : Concrete lofts will be provided in kitchen & 1 bedroom (Wherever feasible).
- Finishes** : Internal Surface will be finished with two coat of path with Acrylic Emulsion Paint.
Exterior Surface shall be finished wirth ACE acrylic emulsion paint.
- Staircase** : Railing - MS Grill.
- Rainwater** : Rain water harvesting will be done.
- Pest control** : Pre construction anti-termite treatment.
- Invertor Point** : Will be provided.

PAYMENT SCHEDULE

At the time of Booking	10%
At the time of basement	10%
At the time of UDS Registration	40%
At the time of complete roof slab	30%
At hte time of Brick work & Plaestring	5%
At the time of handing over the flat	5%



2/3 V.O.C Nagar, 2nd Street, Anna Nagar East, Chennai - 600 102.

Tel : 044-3200 0032 & 4509 0323, Mob : 95514 55000, 98410 69000

Email : identityaccounts@yahoo.com

Contact

www.sdrconstruction.in